

BILLYCART PLAN

Key and Timber List					
Number	Name	Long	Wide	Thick	Material
1	Centre board	1030mm	90mm	35mm	pine
2	Steering board	470mm	140mm	35mm	pine
3	Back axle board	470mm	90mm	35mm	pine
4	Seat supports (2)	165mm	90mm	35mm	pine
5	Seat base	470mm	300mm	-	5-ply

Key and Timber List					
Number	Name	Long	Wide	Thick	Material
6	Seat sides (2)	280mm	90mm	19mm	pine
7	Seat back	470mm	90mm	19mm	pine
8	Brake handles (2)	300mm	40mm	19mm	pine
9	Brake blocks (2)	90mm	50mm	19mm	pine
10	Stop block	135mm	100mm	35mm	pine

To enable a fair contest, the following billy cart design restrictions are necessary (traditional races only):

- 1) Length - Billycarts must not be longer than 1.6m (160cm).
- 2) Width - Billycarts must not be wider than 1 metre.
- 3) Wheels - Each wheel's diameter must not exceed 30cm.
- 4) Seat - All billycarts must have a stable seat or platform.
- 5) Steering - Billycarts need to have a reliable form of steering.
- 6) Billycarts must be free of any sharp or dangerous edges.
- 7) Billycarts must be pushed by one person at a time (no other form of power is allowed).
- 8) Ball bearing wheels are allowed.

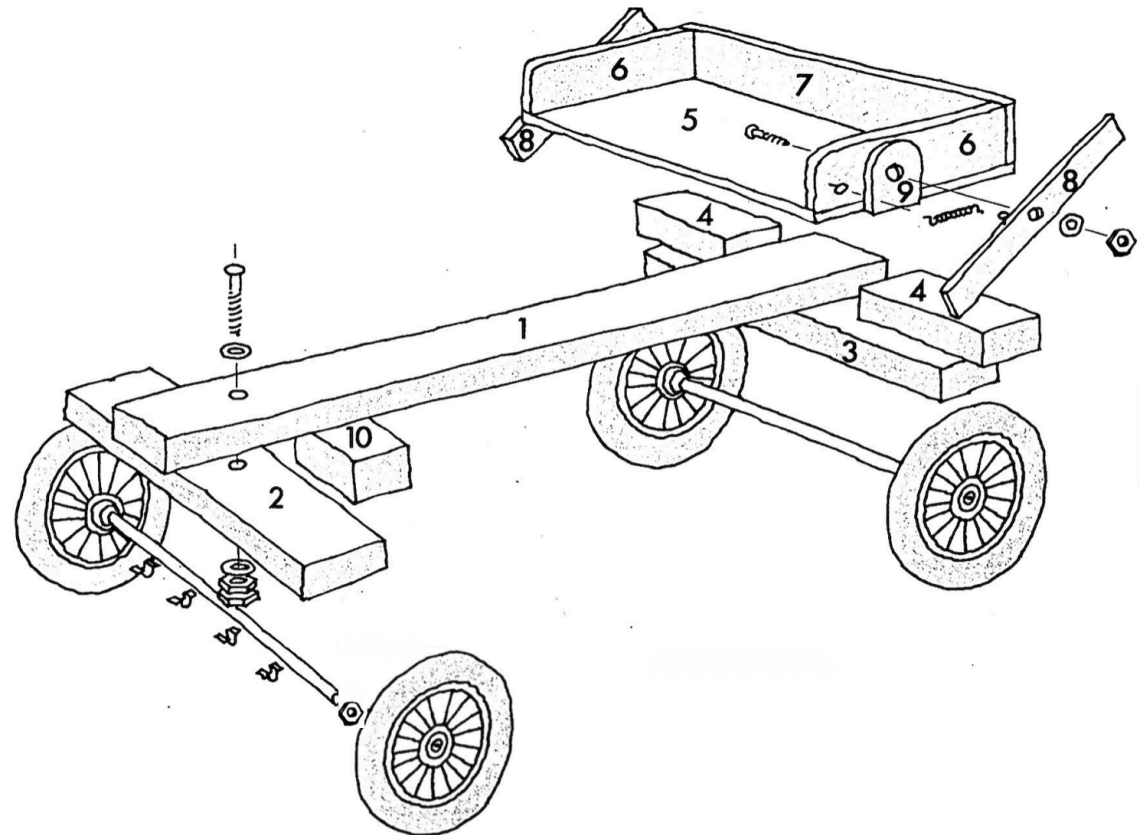

PLANNING

Billicarts are great fun to drive. Here's how you can make a billicart of your own. Some of the tools you will have to use can be dangerous if they aren't used correctly, so it might be a good idea to have an adult help you.

DRAWING A PLAN

It is always useful to draw a plan. That way you can work out what materials you need. If you make a list and collect everything you need before you begin, you will find it making the billicart much easier.



MAKING THE SEAT AND BRAKES

You need to cut four pieces of wood to make the seat. Use thick plywood for the base of the seat and pine for the sided and back. You will need:

- ✓ **A back** - One piece of pine, 90 millimetres wide and 470 millimetres long.
- ✓ **Sides** - Two pieces of pine, 90 millimetres wide and 280 millimetres long.
- ✓ **A base** - One piece of plywood, 300 millimetres wide and 470 millimetres long.

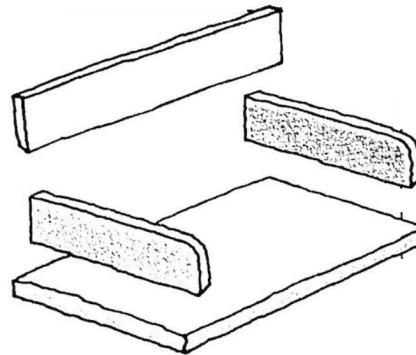

- 1) Measure your timber and mark ready for cutting.
- 2) Use a handsaw, as you did earlier, to cut the wood.

